

# Metallic Sealless Pump

- ✓ **Optimal Performance**
- ✓ **Ease of Maintenance**
- ✓ **Long Service Life**
- ✓ **Higher Process Temperature Range**

[WWW.INVESTAPUMPS.COM](http://WWW.INVESTAPUMPS.COM)

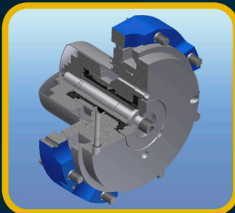

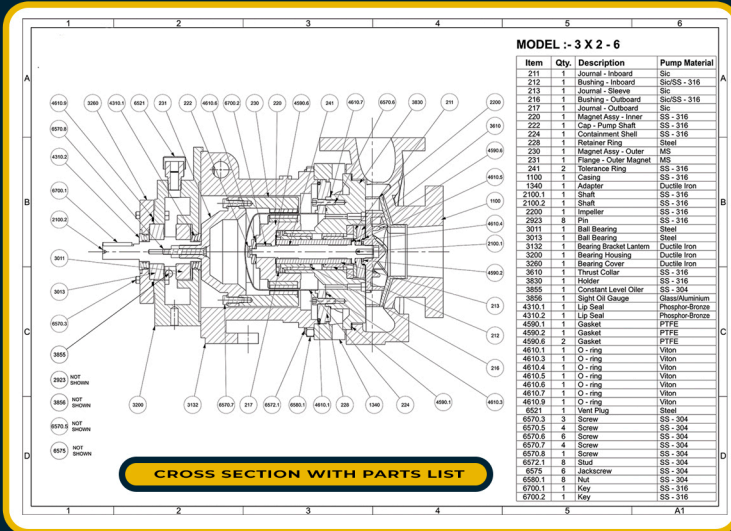

## Main Features

- ✓ High-Performance Reverse Vane Enclosed Impeller Leading to Low NPSHr, Ensures Continuous Bearing Lubrication and Low Thrust Capabilities.
- ✓ Standard SmCo Magnets for Pumping Liquids up to 290° Celsius.
- ✓ Extremely Close and Tight Running Clearances avoids potential damage.
- ✓ Various Containment Shell Options.
- ✓ Contained Back Pull Out Design Ensures Much Safety while Maintenance. The Process fluid remains fully confined preventing the maintenance person from having any exposure to the Toxic liquid inside.
- ✓ Silicon Carbide Bushings and Journals are mounted using Tolerance rings to tackle Thermal Expansion and have High-Temperature Capabilities.

## Performance Range Chart

### Flow Rate -(50 Hz)

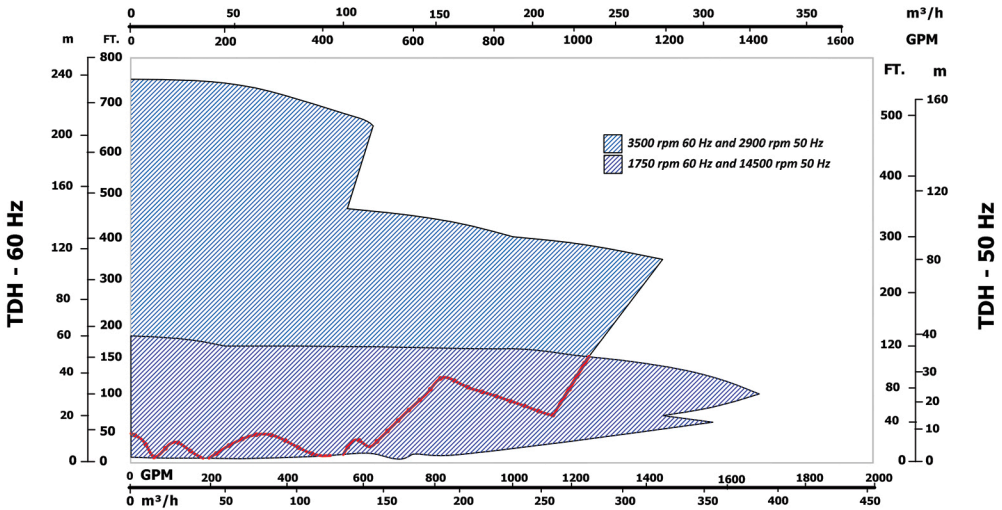

### Flow Rate -(60 Hz)

## Operating Parameters

- Max. Flow : 120 cu.m/hr.
- Max. Pressure: 7 Bar.
- Max. Temperature: 290° Celsius.
- Offered in: 316 SS, Alloy 20 and Hast C 276.

## Other Options

- Closed Coupled Design Available.
- Labyrinth Oil Seals.
- A Pump Power Monitor can be provided.
- Higher Sizes Under Development.

**investa**<sup>TM</sup>

Performance is everything



**WORKS**

Plot#762, Phase II,  
G.I.D.C., Gundlav,  
Gujarat. INDIA.

**OFFICE**

3-Hind Service Industries,  
Shivaji Park, Dadar,  
Mumbai 400 028. INDIA.

**INQUIRY**

+91-022-2446 0630  
+91-022-2446 0631

**EMAIL**

office@investapumps.co.in

**WWW.INVESTAPUMPS.COM**